

# Maia™ Task Light

Part#: 69E11X-FF

## INSTALLATION INSTRUCTIONS

PARTS NEEDED:	
	
Maia Desk Lamp	Class 2 Power Supply

### IMPORTANT SAFETY INSTRUCTIONS. READ CAREFULLY FOR YOUR PROTECTION AND SAVE ALL INSTRUCTIONS

To avoid a hazard to children, account for all parts and destroy all packaging materials.

Do not use in a wet location

Use wire management to ensure that any excess cords are tucked away and will not pose a tripping hazard.

#### Handling

When carrying the lamp, one hand should support the base and the other hand should support the vertical arm. The lamp should never be carried by the horizontal or vertical arm alone.

#### Cleaning Instructions

Use a soft, dry cloth to clean or dust the lamp. Do not use alcohol, abrasives or harsh solvents.

### 1. To power the light:

Attach power cord on lamp to power supply provided. Plug power supply into wall.



### 2. Operating lamp:

Press the on/off button on the underside of the lamp head or on the base to turn the light on. Holding the button down will increase/decrease the intensity. Press again to turn off. With optional occupancy sensor, lamp will turn off & restart automatically.

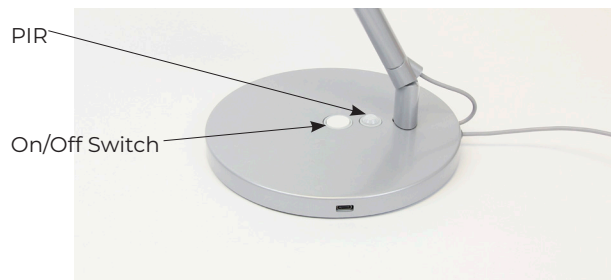

3030 Corporate Grove Dr.  
Hudsonville, MI 49426  
Phone: 616.396.1355

[itc-us.com](http://itc-us.com)

For warranty information please visit [www.itc-us.com/warranty-return-policy](http://www.itc-us.com/warranty-return-policy)  
DOC #: 710-00196 · Rev A · 08/31/21

**3. Lamp head and base swivel adjustment:**

The head adjusts up-and-down and the base swivel allows side-to-side movement.

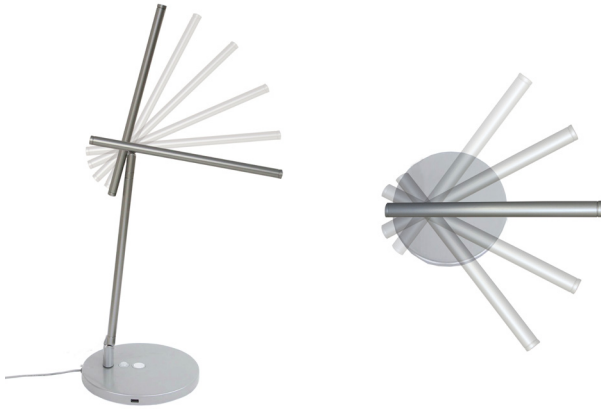

**4. Lamp arm adjustment:**

The lamp arm adjusts to place light just where it's needed.



**5. USB Charging Option:**

The optional USB charging base comes standard with USB-A and USB-C ports to allow for charging of electronic devices. Additionally, the occupancy sensor and on/off switch are built into the base.

